

# AMERICAN COUNTESS™

The newest jewel in America's premier riverboat fleet, this bold paddlewheeler boasts a sleek, contemporary design effortlessly hosting up to 245 guests. Amidst ample open spaces are ideal for gatherings while large forward-facing windows and a portside bar with an 80-foot-high window-wall afford incredible views.

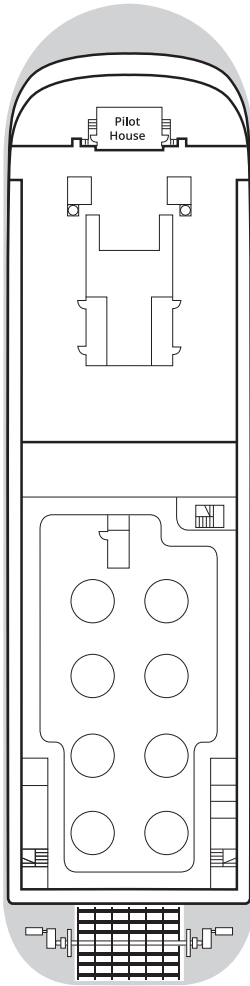

**DECK 4  
SUN DECK**  
Pilot House

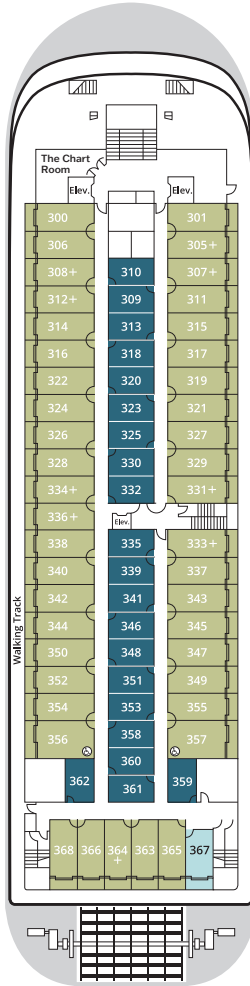

**DECK 3  
OBSERVATION DECK**  
The Chart Room  
Walking Track  
Staterooms

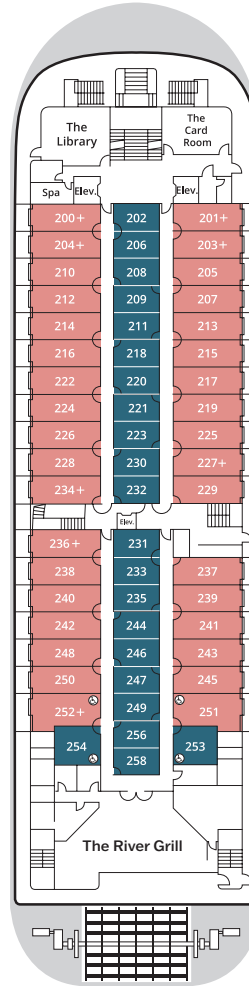

**DECK 2  
CABIN DECK**  
The Library  
The Card Room  
Spa  
The River Grill  
Staterooms

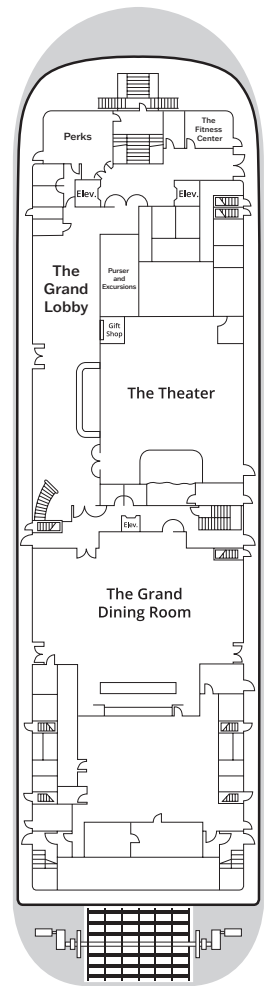

**DECK 1  
MAIN DECK**  
Perks  
The Fitness Center  
The Grand Lobby  
The Theater  
The Grand Dining Room  
Purser & Excursions Desk  
The Gift Shop

† Triple Occupancy

## STATEROOM CATEGORIES

<b>A</b>	Deluxe Outside Stateroom with Private Veranda	DECK 2
<b>B</b>	Outside Stateroom with Open Veranda	DECK 3

<b>E</b>	Inside Stateroom	DECK 2 DECK 3
<b>SO</b>	Single Outside Stateroom with Open Veranda	DECK 3

Accessible Staterooms  
Staterooms 251-254, 356 and 357 feature a roll-in shower.

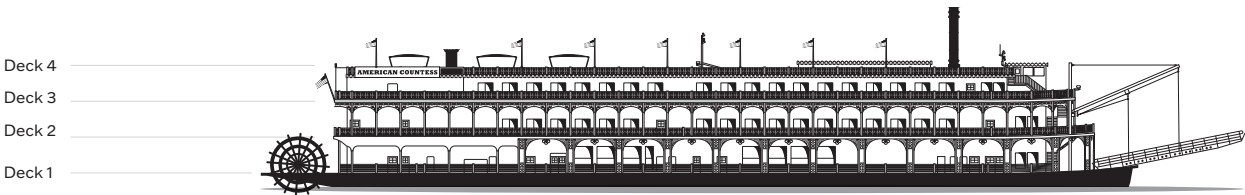

SPECIFICATIONS

Year Built/Refurbished .....	1996/2020	Staterooms .....	123
Length .....	361 Ft.	Guests .....	245
Guest Decks .....	4	Crew .....	98





## STATEROOMS

*Aboard the American Countess, relax in a comfortable atmosphere with modern amenities. Premium linens and plush bedding ensure that you are well-rested to fully enjoy all included shore excursions, historical lectures and nightly entertainment. For your comfort and convenience, each elegant accommodation boasts a flat-screen TV, mini refrigerator, coffee maker and safe.*

### DELUXE OUTSIDE STATEROOM WITH PRIVATE VERANDA | 226 SQ. FT.

A



These staterooms offer the perfect break from a busy day on the river. Settle in at your desk or relax on the couch, open the doors to your veranda and peacefully watch the riverbanks of America's heartland drift by.



- Queen bed or two single beds
- Full bathroom with shower
- Safe, Bathrobes and Slippers
- Sitting area with sofa and desk
- Flat-screen TV
- Sliding doors open to private veranda
- Interior access
- Located on Cabin Deck

*Accessible staterooms 251 and 252 are 289 sq. ft., and feature a roll-in shower*

### OUTSIDE STATEROOM WITH OPEN VERANDA | 192 SQ. FT.

B



Start your morning on the river by opening sliding doors to enjoy fresh air and picturesque landscape as we gently drift past. Indulge in some snacks on the deck outside your stateroom, socialize with fellow guests or simply enjoy a luxurious day of lounging.



- Queen bed or two single beds
- Full bathroom with shower
- Safe, Bathrobes and Slippers
- Sitting area with chair and desk
- Flat-screen TV
- Sliding doors open to deck
- Interior access
- Located on Observation Deck

*Accessible staterooms 356 and 357 are 265 sq. ft., and feature a roll-in shower*



THE GRAND LOBBY

## INSIDE STATEROOM | 153 SQ. FT.

E



Our Inside Staterooms invite you to relax and unwind in modern comfort. These spaces offer a tranquil retreat in which you can feel at home on the river and prepare for exciting days brimming with fun activities.

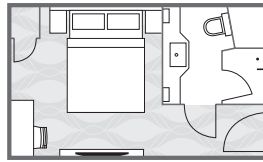

- Queen bed or two single beds
- Full bathroom with shower
- Safe, Bathrobes and Slippers
- Writing desk with chair
- Flat-screen TV
- Interior access
- Located on Cabin and Observation Deck

*Accessible staterooms 253 and 254 are 239 sq. ft., and feature a roll-in shower*

## SINGLE OUTSIDE STATEROOM WITH OPEN VERANDA | 155 SQ. FT.

SO



This intimate accommodation provides solace and solitude between exploring the vessel and venturing onshore. You will want for nothing in this home away from home on the water, with its deck access and convenient location.

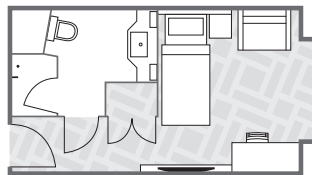

- Single bed
- Full bathroom with shower
- Safe, Bathrobes and Slippers
- Sitting area with chair and desk
- Flat-screen TV
- Sliding doors open to deck
- Interior access
- Located on Observation Deck

*Accessible Staterooms: The American Countess' three elevators provide access to Decks 1 – 3. 251 – 254, 356 and 357 are wheelchair-accessible, and feature a roll-in shower.*



THE LIBRARY



THE CARD ROOM